

# HTemp-485 Box2

## RS-485 humidity and temperature sensor

An RS-485 digital temperature and humidity sensor. The sensor has minimal power consumption and can be powered from a wide power supply range. It can be connected to Poseidon 1250 and 2251.

- Measured temperature and humidity are sent already in °C or % of humidity using a simple text protocol.
- You can connect up to 32 sensors over a 4-wire bus that contains a RS-485 line and a power source, up to the distance of 1000m.



HTemp-485 Box2 uses an integrated temperature element with  $\pm 0,5^{\circ}\text{C}$  accuracy, Humidity is measured using a polymer sensor.

RS-485 protocol is compatible with Temp-485 sensor, measured values of temperature and humidity are read over RS-485 bus as two independent measurements, each with different address. So each H-Temp device has two different RS-485 communication addresses. Capital letter stands for temperature address, small letter for humidity address.

### Applications

- Industry measurement and regulation – large temperature measuring systems
- Temperature measuring of storage, industrial or residential premises.
- When connected to a Poseidon device – measurements in technological premises and data transfer over Ethernet network

### Basic features

- Relative humidity measurement from 0% to 100%
- Temperature measurement form  $-10^{\circ}\text{C}$  up to  $+85^{\circ}\text{C}$
- RS-485 communication
  - Compatible with Poseidon model 1250
  - Compatible with Poseidon model 2251
- LED indication of reading the values
- Minimum power consumption, no need for voltage regulation
- DIP switch selectable RS-485 termination
- Sensor address can be set:
  - Using jumpers
  - In terminal SETUP mode
- Easy wall mounting

## Parameters

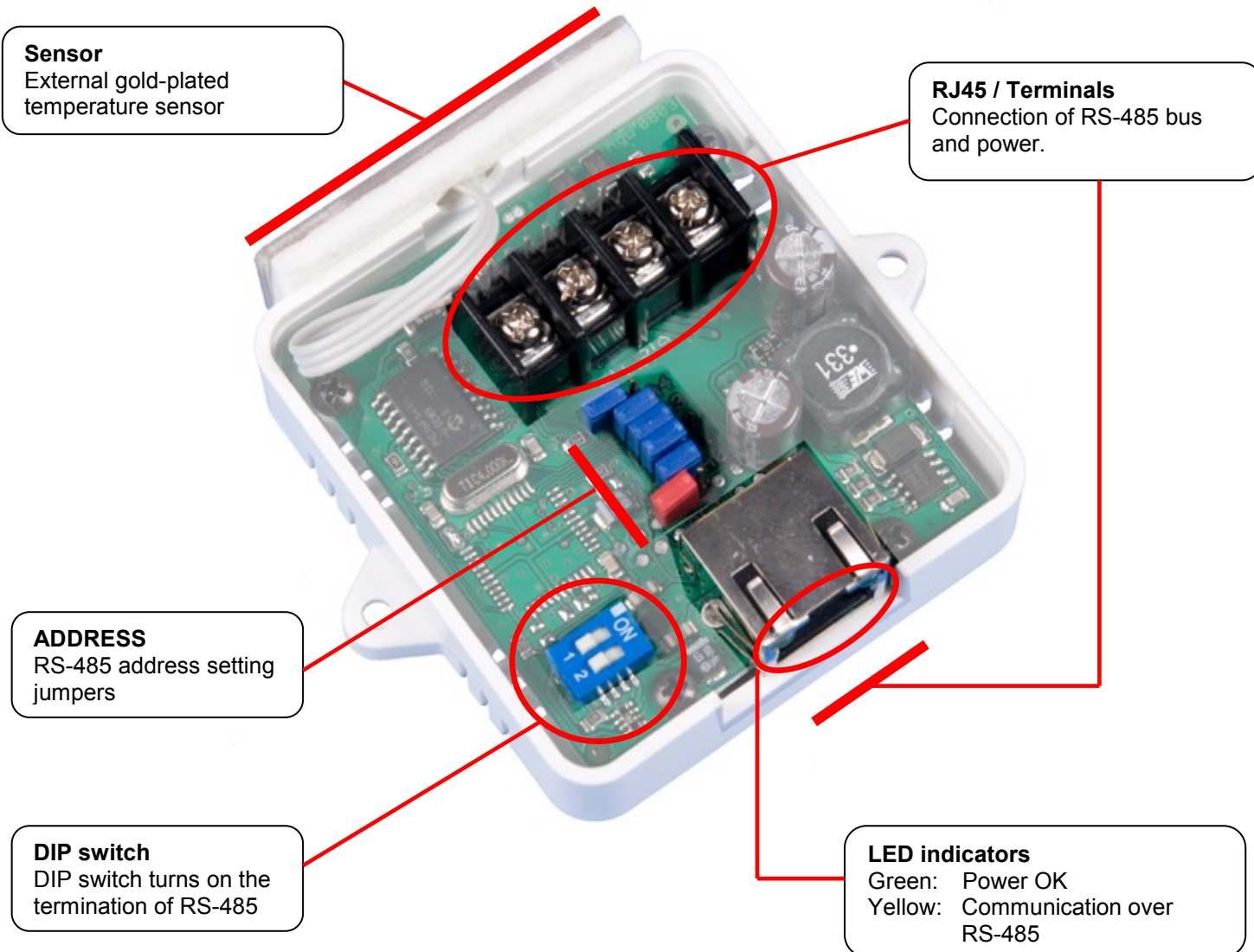

Measured temperature range.....-10°C up to +70°C

Temperature measurement accuracy ..... +/- 0,5 °C

Measured humidity range.....0% to 100%

Humidity measurement accuracy.....± 2% in range from 0% to 90% (15°C to 30°C)

Measuring element of humidity sensor ..... Polymeric sensor

Setting RS-485 address..... Jumper or SETUP mode

**Power voltage**..... +8V to +30V DC, polarity reversing protection

RS-485 termination ..... Optional (DIP1 and 2), always 10 kΩ for idle state of the line

Wire connection ..... Terminal board / RJ45

Outer box dimensions: ..... 80 x 64 x 67 mm (IP20)

Wall mounting: ..... Mounting the sensor on the wall by two screws

Ordering number		
600 343	HTemp-485 Box2	Indoor temperature and humidity sensor with RJ45 and terminal for RS-485 connection